

- NOTES:
- CONTRACTOR SHALL FIELD LOCATE ALL PIPE AND DRAIN LOCATIONS. ACTIVE PIPES AND DRAINS SHALL BE ADJUSTED OR RELOCATED PER THE DETAIL ON SHEET 32 AND AS DESCRIBED IN THE GENERAL NOTES, SHEETS 2 - 3. PIPE AND DRAIN ELEVATION SHOWN REFLECT THOSE RECORDED AT EXISTING STREAM DAYLIGHT LOCATIONS.
 - SEE SHEETS 30 - 32 FOR PROP. TYPICAL TWO STAGE DITCH SECTION, BANK STABILIZATION, OUTSIDE MEANDER BRANCH LAYERING, AND OTHER STANDARD RESTORATION FEATURE DETAILS.
 - REFER TO SHEETS 5-8 FOR PARCEL INFORMATION.

GENERAL NOTES

LEGEND

- P/L PROPERTY LINE
- 960 EX. CONTOURS
- 685 PROP. CONTOURS
- EX. ALIGNMENT
- EX. LEFT TOP OF BANK
- EX. RIGHT TOP OF BANK
- EX. WETLAND
- EX. TREE TO REMAIN
- EX. RIPARIAN SETBACK
- FEMA FLOOD HAZARD AREA (100-YR)
- FEMA FLOODWAY
- EX. RIGHT-OF-WAY
- PROP. PERMANENT DITCH EASEMENT
- PROP. TEMPORARY DITCH EASEMENT
- PROP. SUPPLEMENTAL DITCH/ACCESS EASEMENT (PERMANENT)
- PROP. THALWEG
- PROP. FLOODPRONE AREA EXPANSION
- PROP. RIFFLE
- PROP. BANK STABILIZATION
- PROP. STAGING AREA
- PROP. LIMITS OF DISTURBANCE
- PROP. SITE ACCESS
- PROP. SPOIL AND GRADING
- PROP. GRADE CONTROL
- PROP. OUTSIDE MEANDER LOG/BRANCH HABITAT

PROFILE LEGEND

- EX. GROUND SURFACE
- PROP. THALWEG
- EX. RIGHT TOP OF BANK
- EX. LEFT TOP OF BANK
- PROP. BANKFULL BENCH EL.

NO.	REVISION/ISSUE	DATE

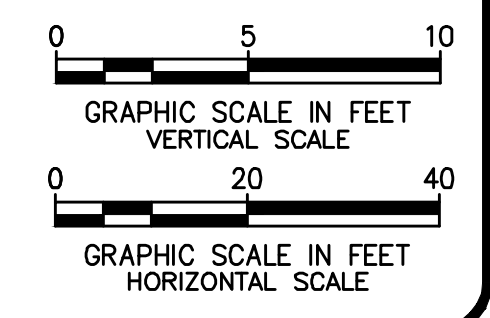
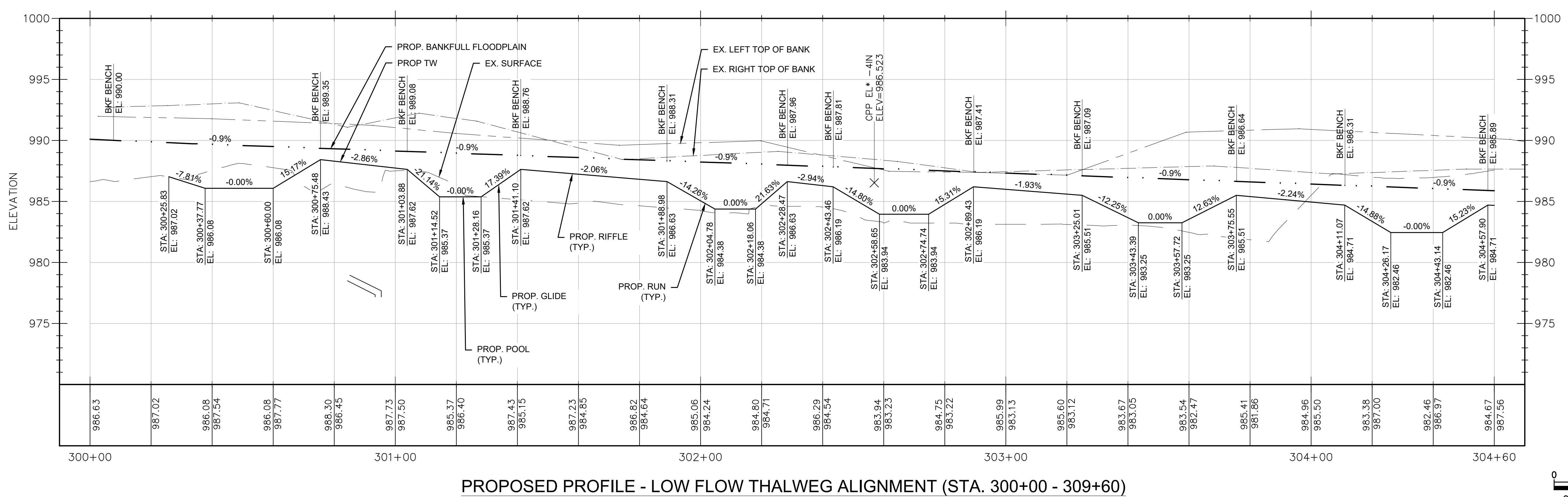

BID SET

ES EnviroScience
 Excellence in Any Environment
 Headquarters: 5070 Stow Road, Stow, OH 44224
 800-940-4025 | EnviroScienceInc.com

SUMMIT COUNTY ENGINEER
 538 EAST SOUTH STREET
 AKRON, OH 44311

COPLEY DITCH (COUNTY DITCH NO. 38) STORM WATER DETENTION & WETLAND AREAS

PLAN & PROFILE

WORK AREA 2
 STA. 300+00 - 304+56.89

DESIGNED BY: AH
 DRAWN BY: TG
 CHECKED BY: JB

DATE: MAY 19, 2026

VERT. SCALE: 1" = 5'
 HORIZ. SCALE: 1" = 20'

SHEET: 16 / 55

C:\USERS\HORIZONE\WORK\AKRON\RESTORATION\CAD\TASKS\COPLEY_MEANDER\FINAL_DESIGN\CAD\PROFILES\PROFILE.DWG - 16.PRF 01 - 5/12/2026 11:02:24 AM - ANGELO.M.HOTZ